

AlumaFeed™ Synergic Aluminum Welding System

Issued Oct. 2011 • Index No. DC/34

MIG Arc Welding Power Source 

Quick Specs

Industrial Applications

Boat, Ship and Yacht Building
Recreational Vehicles
Trucks and Trailer
Sign Manufacturers
Emergency Vehicles

Processes

Aluminum MIG (GMAW)
Aluminum Pulsed MIG (GMAW-P)
Aluminum Synergic Pulsed MIG

XR-AlumaFeed

Input Power 24 VAC, 50/60 Hz

Wire Feed Speed

50–900 IPM (1.3–22.9 m/min.)

Weight 42.5 lb. (19.2 kg)

AlumaPower 350 MPa and 450 MPa

Input Power 350: Requires 3- or 1-Phase Power, 208–575 VAC, 50/60 Hz

450: Requires 3-Phase Power, 230/460 VAC, 60 Hz

Rated Output 350: 10–38 V, 5–425 A
450: 10–38 V, 15–600 A

Net Weight 350: 80 lb. (36.3 kg)
450: 122 lb. (55.3 kg)

The Power of Blue.®

The XR-AlumaFeed™ and AlumaPower™ 350 MPa or new 450 MPa combine for a synergic system that simplifies and improves MIG and Pulsed MIG welding applications for aluminum welding.

Ultra portable and versatile.

The slim ergonomic design of the XR-Aluma-Pro torch allows access into the tightest of quarters. Coupled with the XR-AlumaFeed feeder and the AlumaPower 350 MPa or 450 MPa synergic power supply, it has the features for all of your aluminum fabrication needs.

Synergic pulsed welding mode

offers the simplicity of single-knob control. The machine will select the correct pulse power based on the wire feed speed (WFS) set by the operator.

Profile Pulse.™ Achieve “stacked dime” weld bead appearance without back-stepping. See page 2 for more information.

Parameter and system lock provides three levels of protection to prevent accidental modification of welding parameters or manipulation of setup menu items.



New!

AlumaFeed Synergic Aluminum Welding System with AlumaPower 450 MPa and XR-Aluma-Pro gun shown.

Comes Complete With:

- XR-AlumaFeed™ push-pull wire feeder
- AlumaPower™ 350 MPa *OR* 450 MPa power source
- XR-Aluma-Pro™ *OR* XR™-Pistol Grip push-pull welding gun
- .035- and 3/64-in. (0.9 and 1.2 mm) contact tips, drive roll and liners for guns
- .035- and 3/64-in. (0.9 and 1.2 mm) drive rolls for wire feeder, 3/64-in. installed

Note: All AlumaFeed systems come setup out of the box to run 3/64-in. (1.2 mm) 5356 wire.

Order weld cables and other accessories separately.

True push-pull wire feed system. Slave/torque motor ensures smooth, consistent feeding and improved arc performance, while reducing the problems normally associated with feeding aluminum.



AlumaFeed Synergic Aluminum Welding System also available with XR-Pistol Grip gun.



Welder/generator is warranted for 3 years, parts and labor.
Original main power rectified parts are warranted for 5 years.
Gun warranted for 1 year, parts and labor.

MADE IN **USA**
APPLETON, WI **USA**



Miller Electric Mfg. Co.
An Illinois Tool Works Company
1635 West Spencer Street
Appleton, WI 54914 USA

Equipment Sales US and Canada
Phone: 866-931-9730
FAX: 800-637-2315
International Phone: 920-735-4554
International FAX: 920-735-4125

Web Site
www.MillerWelds.com



AlumaFeed™ Synergic Aluminum Welding System Features

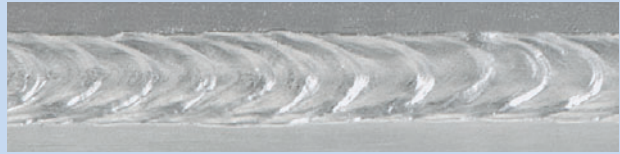

Profile Pulse™ Achieve “stacked dime” weld bead appearance without back-stepping. Profile Pulse frequency can be changed to increase or decrease the spacing between the ripple pattern to achieve the desired weld appearance.

Weld Cross Section



Hot Start Off



Hot Start On

Begin and end welds with ease and confidence. **Hot Start™** eliminates incomplete fusion at the beginning of a weld, a common issue with aluminum welding. **Crater** gradually decreases weld current at the end of a weld to eliminate crater defects. Adjustable pre- and post-flow rates ensure that the puddle always has adequate gas coverage.



Flowmeter. Standard integrated flowmeter helps to regulate and maintain proper gas flow rate. Helpful when feeder is located long distances from gas supply. Helps ensure weld quality.



Gun bushing. Improved gun connection uses a bushing that captures the power end of gun to ensure correct alignment to drive rolls and provides exceptional ruggedness and durability.

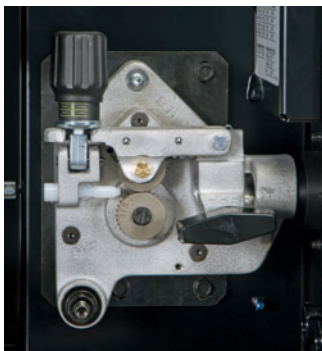

Drive assembly. Improved drive assembly with numeric scale for different wire sizes prevents wire slippage and deformation. Helps improve wire feeding by making sure the proper drive-roll tension is used. Comes factory-installed with 3/64-inch drive rolls.

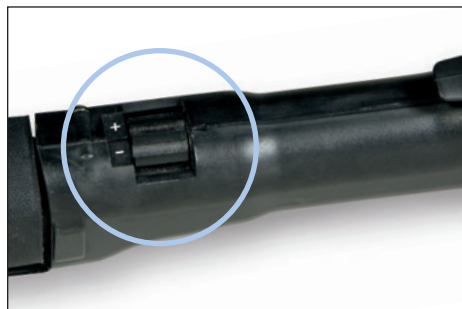

Synergic “one-knob” control. Set the wire feed speed control on the gun and the system handles the rest, greatly simplifying set-up and reducing training time. No need to travel back to the power source to change multiple parameters.

XR-AlumaFeed™ Wire Feeder

Gun calibration allows control box to sync with the welding gun for precise wire feed control that is critical for reducing weld defects and providing flawless synergic operation.

Advanced trigger provides “trigger interlock” capability and the ability to control the amount of time spent in the arc start and arc crater steps.

Bright digital displays are easy to read, and display voltage or arc length and wire feed speed or amperage. Also have indicators for start and crater, setup, schedule select and advanced trigger operations. Two-knob, three-button panel layout makes it simple to change parameters and reduces training time.



Trigger schedule select (SCHD) allows the operator to select the alternative schedule by quickly tapping the gun trigger when not welding. Useful when switching between two welding parameters is needed.

Setup guide on inner panel of feeder has quick tips to get your system up and running quickly. Also provides a good reference that won't get misplaced like an owner's manual.

Rugged steel case holds up in the harshest environments and protects wire from dirt and moisture. Also has a large carrying handle for improved durability.

XR-AlumaFeed Specifications (Subject to change without notice.)



Input Power	Input Welding Circuit Rating	Wire Speed	Wire Diameter Range	Maximum Spool Size Capacity	Dimensions	Net Weight
24 VAC, 5 A, 50/60 Hz	400 A at 100% Duty Cycle System duty cycle is limited to gun rating	50–900 IPM (1.3–22.9 m/min.)	Aluminum: .035–.062 in. (0.9–1.6 mm) Solid Wire: .035–.045 in. (0.9–1.2 mm) Drive roll kit #195 591 required to run 1/16-in. (1.6 mm) wire	12 in. (305 mm)	H: 16 in. (406 mm) W: 9.5 in. (241 mm) D: 21.25 in. (540 mm)	42.5 lb. (19.2 kg)

XR-AlumaFeed Control Panel

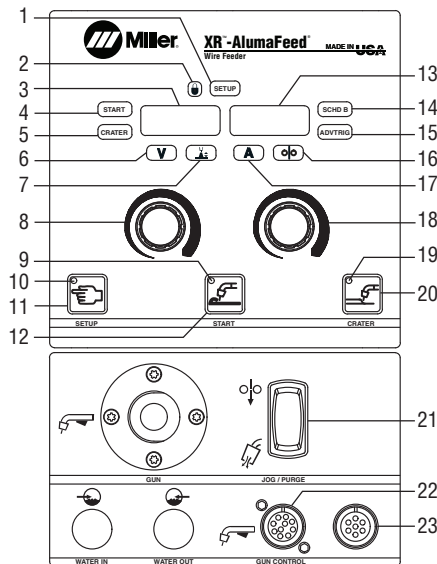

- 1. Setup Menu Indicator
- 2. Lock Indicator
- 3. Left Display
- 4. Start Menu Indicator
- 5. Crater Menu Indicator
- 6. Volts Indicator
- 7. Arc Length Indicator
- 8. Left Adjust Knob
- 9. Start On Indicator
- 10. Setup Indicator
- 11. Setup Button
- 12. Start Button
- 13. Right Display
- 14. Schedule B Indicator
- 15. Advanced Trigger Indicator
- 16. Wire Speed Indicator
- 17. Amps Indicator
- 18. Right Adjust Knob
- 19. Crater On Indicator
- 20. Crater Button
- 21. Jog/Purge Switch
- 22. Gun Connector
- 23. Optional Remote Connector

Power Source Compatibility for XR-AlumaFeed Wire Feeders

Power Source	Pulse Capable	Synergic Pulsed MIG	Profile Pulse Capability	Electronic Inductance/SharpArc	Compatibility
AlumaPower™ 350 and 450 MPa	Yes (Aluminum only)	Yes (Aluminum only)	Yes	Yes	Optimized
Invision™ 352 and 450 MPa	Yes	Yes	Yes	Yes	Best
XMT® 350 and 450 MPa	Yes	Yes	Yes	Yes	Best
XMT® 350 and 450 CC/CV	Yes (with Optima)	No	No	Yes	Better
XMT® 304 CC/CV	Yes (with Optima)	No	No	Yes	Better
Invision™ 456P	Yes (with Optima)	No	No	Yes	Better
Invision™ 456MP	Yes	No	No	Yes	Better
Invision™ 354P	Yes (with Optima)	No	No	Yes	Better
Invision™ 354MP	Yes	No	No	Yes	Better
Deltaweld® (after KF790532)	No	No	No	No	Good

Note: Power sources not included in this list are not recommended. For specific information, please contact your local Miller distributor.



XR-Aluma-Pro™ Specifications (Subject to change without notice.)

Model	Welding Output Range with 100% Argon and Peak Amperages	Electrode Wire Diameter Capacity	Wire Speed	Dimensions	Net Weight (Torch only)
XR-Aluma-Pro Air-Cooled Gun	300 A at 100% Duty Cycle with 15-, 25-, or 35-ft. (4.6, 7.6, or 10.6 m) gun	.030–1/16 in. (0.8–1.6 mm) Aluminum Wire kit #230 708 required to run 1/16-in. (1.6 mm) wire	70–900 IPM (1.8–23 m/min.) dependent on feeder used.	H: 5 in. (127 mm) W: 2.5 in. (64 mm) D: 17 in. (432 mm)	2.5 lb. (1.1 kg)
XR-Aluma-Pro Water-Cooled Gun	400 A at 100% Duty Cycle with 15-, 25-, or 35-ft. (4.6, 7.6, or 10.6 m) gun	.030–1/16 in. (0.8–1.6 mm) Aluminum Wire kit #230 708 required to run 1/16-in. (1.6 mm) wire	70–900 IPM (1.8–23 m/min.)	H: 5 in. (127 mm) W: 2.5 in. (64 mm) D: 17 in. (432 mm)	2.9 lb. (1.3 kg)

 Certified by Canadian Standards Association to both the Canadian and U.S. Standards.  Conforms to European standards.

XR-Aluma-Pro Parts Breakdown

XR-Aluma-Pro A Gun

(Air-Cooled Parts Breakdown and Gun Shown)

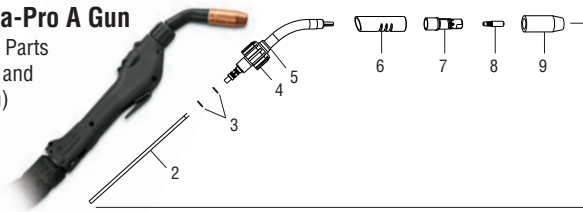

- | | | | |
|--------------------------------------|-----------|--|-----------|
| 1. Air-Cooled Assembly | | 6. Outer Insulating Jacket | |
| Short Head Tube, 4 in. | #231 519 | Short | #227 159 |
| Long Head Tube, 6 in. | #231 518* | Long | #229 673 |
| 2. Head Tube Liner (See chart below) | | 7. Gas Diffuser | #229 670 |
| 3. Head Tube O-Rings | #230 969 | 8. FasTip™ Contact Tip (See chart below) | |
| 4. Lock Nut | #227 168 | 9. Nozzle | #198 855 |
| 5. Insulator Ring Rear | #227 416 | | *Optional |

XR-Aluma-Pro W Gun

(Water-Cooled Parts Breakdown and Gun Shown)

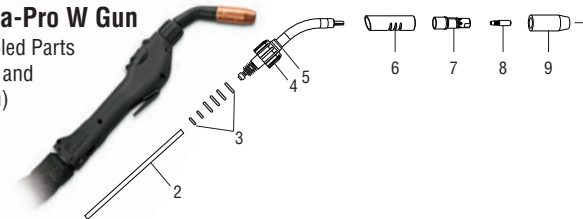

- | | | | |
|--------------------------------------|----------|--|----------|
| 1. Water-Cooled Assembly | | 5. Insulator Ring Rear | #227 416 |
| Long Barrel, 6 in. | #231 517 | 6. Outer Insulating Jacket | #230 420 |
| 2. Head Tube Liner (See chart below) | | 7. Gas Diffuser | #229 670 |
| 3. Head Tube O-Rings | #230 970 | 8. FasTip™ Contact Tip (See chart below) | |
| 4. Lock Nut | #229 889 | 9. Nozzle | #199 618 |

Important: A wider selection of Miller® and Centerfire™ Series consumables are available — see Gooseneck-Style Guns spec sheet (Lit. Index No. M/1.71).

XR-Aluma-Pro Standard Consumables (Order from Miller Service Parts.)

Aluminum Wire Size	FasTip Contact Tip (Qty. 25)	Drive Rolls	Idler Rolls	Inlet Guides	Air-Cooled Head Tube Liner Short Barrel 4 in. (102 mm)	Air- and Water-Cooled Head Tube Liner Long Barrel 6 in. (152 mm)	Cable Liners
.030 in. (0.8 mm)	#206 186 .041 in. ID	#227 434	#230 439	#227 408	#227 161	#229 674	#229 887 15 ft. (4.6 m)
.035 in. (0.9 mm)	#206 187 .047 in. ID	#227 434	#230 439	#227 408	#227 161	#229 674	#229 891 25 ft. (7.6 m)
.040 in. (1.0 mm)	#206 188 .053 in. ID	#227 434	#230 439	#227 408	#227 161	#229 674	#232 321 35 ft. (10.6 m)
3/64 in. (1.2 mm)	#206 189 .061 in. ID	#227 434	#230 439	#227 408	#230 239	#229 431	
1/16 in. (1.6 mm)	#206 191 .071 in. ID	#227 434	#230 710	#230 711	#230 239	#229 431	

XR-Aluma-Pro Genuine Miller® Accessories

Replacement Leather Cable Cover

#234 109 15 ft. (4.6 m)

#234 110 25 ft. (7.6 m)

#234 111 35 ft. (10.6 m)

Protects gun hose and cable assembly from wear and abrasion. Features a full-length velcro seam.

Replacement Short Leather Gun Cover

#234 416

Cover is 17 inches (432 mm).

1/16-inch (1.6 mm) Wire Kit #230 708

Specially designed for 1/16-inch wire. Includes idler roll, head tube liner and inlet guide. Required when running 1/16-inch wires. Not included with standard Aluma-Pro Gun.

Short Head Tube Assembly #231 519

4-inch (102 mm) barrel includes liner. (Standard barrel.)

Long Air-Cooled Head Tube Assembly #231 518

6-inch (152 mm) barrel includes liner. (Optional barrel.)

Phosphorous Bronze Liner (Optional)

#233 999 Long Head Tube (air or water)

#233 998 Short Head Tube (air only)

Hardwire Liner Kit for Steel and Stainless

#198 377 For 15-, 25-, or 35-foot (4.6, 7.6 or 10.6 m) guns

Kit consists of gun head tube liner and feed cable liner. Recommend using .030–.045 inch mild steel or stainless steel electrode wire (.052- and 1/16-inch wire not recommended).

XR™-Pistol Grip Specifications (Subject to change without notice.)

Model	Welding Output Rating	Electrode Wire Diameter Capacity	Wire Speed	Dimensions	Net Weight with Cable Assembly
XR-Pistol Air-Cooled Gun	200 A at 100% Duty Cycle 250 A at 60% Duty Cycle	.030–.062 in. (0.8–1.6 mm) Aluminum	70–875 IPM (1.8–22.2 m/min.)	H: 7.375 in. (187 mm) W: 1.875 in. (48 mm) D: 10.625 in. (270 mm)	15-ft. Cable: 13 lb. (5.9 kg) 30-ft. Cable: 21 lb. (9.5 kg)
XR-W Pistol Water-Cooled Gun	400 A at 100% Duty Cycle	.030–.062 in. (0.8–1.6 mm) Aluminum	70–875 IPM (1.8–22.2 m/min.)	H: 7.375 in. (187 mm) W: 1.875 in. (48 mm) D: 10.625 in. (270 mm)	15-ft. Cable: 14 lb. (6.4 kg) 30-ft. Cable: 21.5 lb. (9.8 kg)

 Certified by Canadian Standards Association to both the Canadian and U.S. Standards.  Conforms to European standards.

XR-Pistol Grip Parts Breakdown (Air-Cooled shown.)

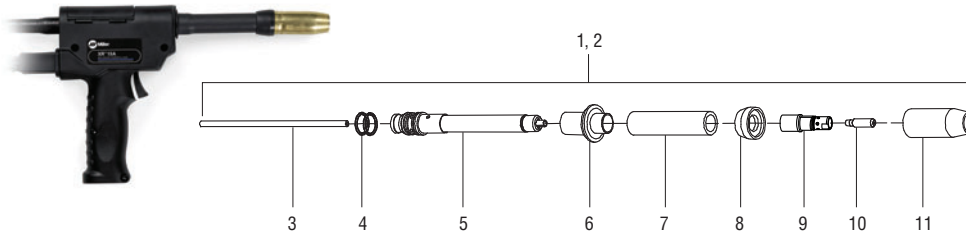

- | | |
|----------------------------|---------------------|
| 1. Air-Cooled Assembly | Kit #231 523 |
| 2. Water-Cooled Assembly* | Kit #231 524 |
| 3. Head Tube Liner | #212 156 |
| 4. O-Ring .614 ID | #134 800 |
| 5. Head Tube (Air-cooled) | #221 087 |
| Head Tube (Water-cooled)* | #221 519 |
| 6. Barrel Pistol Insulator | #219 795 |
| 7. Outer Insulating Jacket | #219 794 |
| 8. Nozzle Insulator | #232 284 |
| 9. Diffuser | #227 749 |
| 10. Contact Tip | (See chart below) |
| 11. Nozzle | #199 613 |

*Order water-cooled parts from Miller Service Parts.

Important: A wider selection of Miller® and Centerfire™ Series consumables are available — see Pistol Grip Guns spec sheet (Lit. Index No. M/1.73).

XR-Pistol Grip Standard Consumables (Air-Cooled Only) (Order from Miller Service Parts.)

Aluminum Wire Size	FasTip Contact Tip (Qty. 25)	Drive Rolls	All-Wire Dual Groove Drive Rolls	Head Tube Liner
.030 in. (0.8 mm)	#206 186 .041 in. ID	#183 357	#136 135	#212 156
.035 in. (0.9 mm)	#206 187 .047 in. ID	#183 357	#136 135	#212 156
.040 in. (1.0 mm)	#206 188 .053 in. ID	#183 357	#136 135	#212 156
3/64 in. (1.2 mm)	#206 189 .061 in. ID	#183 358	#136 135	#212 156
1/16 in. (1.6 mm)	#206 191 .071 in. ID	#183 358	#136 135	#212 156

Cable Liners
#191 065 15 or 30-ft. (4.6 or 9 m)

AlumaPower™ 350/450 MPa Power Source

Auto-Line™ Power Management Technology allows for any input voltage hook-up (208–575 V) with no manual linking required, providing convenience in any job setting. Ideal solution for dirty or unreliable input power. (450 model is manual link.)

Fan-On-Demand™ cooling system operates only when needed, reducing noise, energy use and the amount of contaminants pulled through machine.

Large, dual digital meters are easy to view and are presettable to ease setting weld output.

Inverter arc control technology provides greater puddle control for outstanding MIG and Pulsed MIG weld performance.

Lightweight, aerospace-grade aluminum case offers protection and the benefit of reduced weight.

Ultra-tough, polycarbonate-blended cover for control panel protects front controls from damage.

Easy setup for MIG and Pulsed MIG applications.

Line voltage compensation keeps welding output constant even if input power varies by +/-10 percent. 350 models further expand line voltage compensation to an amazing +37%/-59 percent when operating on 460 VAC.

SharpArc™ controls the arc in Pulsed MIG mode and gives control over the arc cone shape, puddle fluidity, and bead profile. If a gas is used other than Ar 100% (Argon), SharpArc™ can be adjusted to help customize your arc to the gas being used.

Weld Cross Section

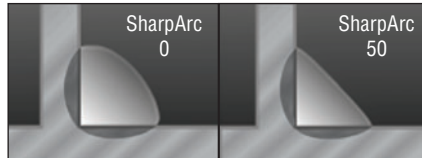

Additional Features

Power factor of .95 enables smaller fuses/breakers and primary wiring. Primary amperage draw at rated output is 25% less than the competition.

Built-in synergic or standard Pulsed MIG capabilities. See the list below of built-in Pulsed MIG (GMAW-P) aluminum programs.

Wire Type	Gas Type
.035 AL 4043	Ar 100% (Argon)
.040 AL 4043	Ar 100% (Argon)
3/64 AL 4043	Ar 100% (Argon)
1/16 AL 4043	Ar 100% (Argon)
.035 AL 5356	Ar 100% (Argon)
.040 AL 5356	Ar 100% (Argon)
3/64 AL 5356	Ar 100% (Argon)
1/16 AL 5356	Ar 100% (Argon)

AlumaPower Specifications (Subject to change without notice.)

CC CV DC 3 Phase 1 Phase (Alum. 450 MPa is 3-Phase only.)

Model	Input Power	Rated Output	Voltage Range in CV Mode	Amperage Range in CC Mode	Max. Open-Circuit Voltage	Amps Input at Rated Load Output, 60 Hz								Dimensions	Weight
						208 V	230 V	400 V	460 V	575 V	KVA	KW			
AlumaPower 352 MPa	Three-Phase	350 A at 34 VDC, 60% Duty Cycle	10–38 V	5–425 A	75 VDC	40.4	36.1	20.6	17.8	14.1	14.2	13.6	H: 17 in. (432 mm) W: 12.5 in. (318 mm) D: 24 in. (610 mm)	80 lb. (36.3 kg)	
	Single-Phase	300 A at 32 VDC, 60% Duty Cycle	10–38 V	5–425 A	75 VDC	60.8	54.6	29.7	24.5	19.9	11.7	11.2			
AlumaPower 450 MPa	Three-Phase	450 A at 38 VDC, 100% Duty Cycle	10–38 V	15–600 A	90 VDC	—	51	—	27.6	—	22	18.9	H: 17.25 in. (438 mm) W: 14.5 in. (368 mm) D: 27.125 in. (689 mm)	122 lb. (55.3 kg)	

Certified by Canadian Standards Association to both the Canadian and U.S. Standards.

AlumaPower Control Panel

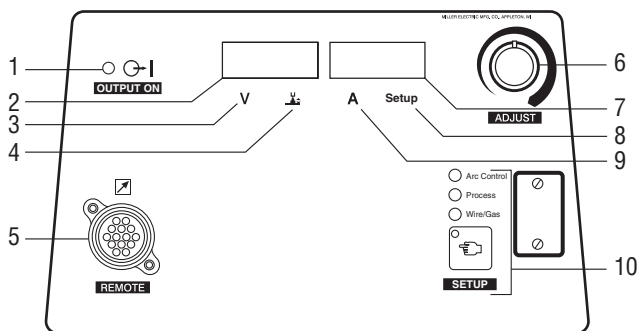

1. Output ON Indicator Light
2. Left Display
3. Voltage Indicator
4. Arc Length Indicator
5. Wire Feeder Receptacle
6. Adjustment Control
7. Right Display
8. Setup Indicator
9. Amperage Indicator
10. Setup Indicator Lights
 - Arc Control Indicator
 - Process Indicator
 - Wire/Gas Type Indicator
 - Setup Button

MPa M (MIG), P (Pulse), a (Advanced Arc Control)

Advanced arc control enables an improved pulse welding arc. The operator has more control over puddle and bead characteristics using SharpArc™. In addition, the unit provides a more robust and stable arc at very low arc length, reducing heat input, and providing the ability to weld on a wider range of material thickness.

What are some benefits of Synergic Pulsed MIG?

1. Easier to set up
2. No more changing wire speed, and then having to go back to the power source to reset the welding output.

Performance Data

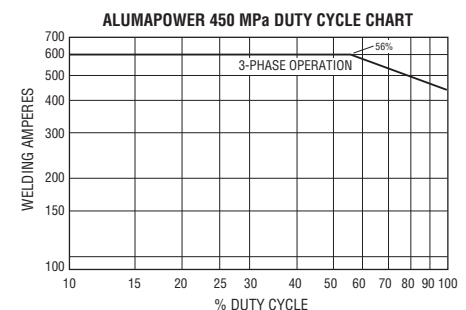
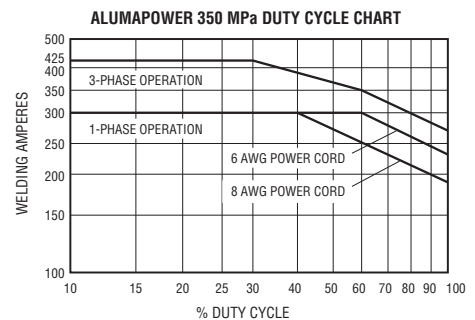

AlumaPower™ Genuine Miller Accessories



Industrial MIG 4/0 Kit with Dinse Connectors #300 405

For AlumaPower 350 MPa power source. Includes Smith® flowmeter/regulator with 10-foot (3 m) gas hose, 10-foot (3 m) 4/0 feeder weld cable with Dinse connector on one end and a lug on the other, 15-foot (4.6 m) work cable with Dinse connector on one end and 600 A C-clamp on the other.

Industrial MIG 4/0 Kit #300 390

For AlumaPower 450 MPa power source. Includes the same as the kit above, except weld and work cables have lugs instead of Dinse connectors.

Remote Control Extension Kits

#242 205 025 25 ft. (7.6 m)

#242 205 050 50 ft. (15 m)

#242 205 080 80 ft. (24.3 m)

Fully loaded 14-pin extension cords for remote controls or 24 V and 115 V feeders.

Cable Connectors and Adapters

Note: AlumaPower 350 power sources are equipped with Dinse-style connectors for secondary connections.



Dinse/Tweco® Adapter #042 465

#042 465

Dinse/Cam-Lok Adapter #042 466

#042 466

One-piece adapter with Dinse-style male plug (to power source) on one end and female receptacle (Tweco or Cam-Lok for weld cable connection) on other end.

Dinse-Style Connector Kit

#042 418

Accepts #4 to #1/0 AWG cable size.

#042 533

Accepts #1/0 to #2/0 AWG cable size.

Kit includes one Dinse-style male plug which attaches to the work and/or weld cables and plugs into the Dinse-style receptacles on the power source.

Extension Kit for Dinse-Style Cable Connectors

#042 419

Accepts #4 to #1/0 AWG cable size.

#042 534

Accepts #1/0 to #2/0 AWG cable size.

Used to adapt or extend weld and/or work cables. Kit includes one male Dinse-style plug and one in-line female Dinse-style receptacle.

AlumaFeed™ System Genuine Miller Accessories

Remote Connector Kit #300 898 Field

Useful when pairing XR-AlumaFeed with an automated system. Allows remote trigger function, or remote voltage or arc length when used with XR-Aluma-Pro™ or XR™-Pistol guns and remote. See Aluma-Pro (Index No. M/1.73) or XR-Pistol (Index No. M/1.71) literature sheets for gun stock numbers.

Safety Water Flow Shutdown Switch #300 905 Field

#300 905 Field

Switch used in conjunction with a coolant system to shut off weld power if coolant is not flowing.



MIGRunner™ Cart #195 445

#195 445

Small footprint and easily maneuverable, with cylinder rack low enough that you do not have to lift bottles.



Universal Carrying Cart and Cylinder Rack #042 934

#042 934

Holds power source, and gas cylinder up to 56 inches (142.2 cm)

high measuring 6 to 9 inches (15.2 to 22.8 cm) in diameter.

Coolant Systems

For more information, see the Miller Coolant Systems literature sheet, Index No. AY/7.2.

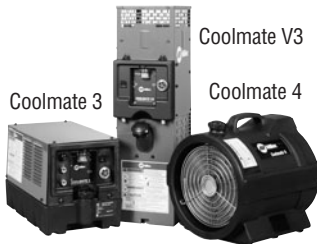

Coolmate V3

Coolmate 4

Coolmate 3

Coolmate™ 3

#043 007 115 VAC

#043 008 230 VAC

For use with water-cooled torches rated up to 600 amps. Unique paddle-wheel indicator, external filter and easy-fill spout.

Coolmate™ V3 #043 009 115 VAC

For use with water-cooled torches rated up to 500 amps. Vertical design conveniently mounts to Miller cylinder rack in place of one cylinder.

Coolmate™ 4 #042 288 115 VAC

For use with water-cooled torches rated up to 600 amps. Tough molded polyethylene case with carrying handle.

Coolant #043 809

Sold in cases of four one-gallon recyclable plastic bottles. Miller coolants contain a base of ethylene glycol and deionized water to protect against freezing to -37 degrees Fahrenheit (-38° C) or boiling to 227 degrees Fahrenheit (108° C). Also contains a compound that resists algae growth.

AlumaFeed 350 MIGRunner™



MIGRunner with 25-foot (7.6 m) air-cooled XR-Aluma-Pro gun shown.

#951 151 with 25-ft. (7.6 m) air-cooled XR-Aluma-Pro gun

#951 152 with 25-ft. (7.6 m) water-cooled XR-Aluma-Pro gun

#951 153 with 30-ft. (9 m) air-cooled XR-Pistol Grip gun

#951 154 with 30-ft. (9 m) water-cooled XR-Pistol Grip gun

Packages include:

- AlumaPower 350 MPa power source (water-cooled packages have 115 V auxiliary power)
- XR-AlumaFeed wire feeder
- Air- or water-cooled XR-Aluma-Pro (gooseneck-style) or XR-Pistol Grip push-pull gun
- MIGRunner Cart
- Industrial MIG 4/0 MIG kit with Dinse connectors
- Gun and feeder drive rolls and consumables to run .035–3/64 inch (0.9–1.2 mm) wire (1/16-inch consumables and water coolant system not included, order separately)

Typical Installations

Note: Cords and cables are supplied unless noted otherwise on drawings below. Refer to Owner's Manual for complete installation instructions.

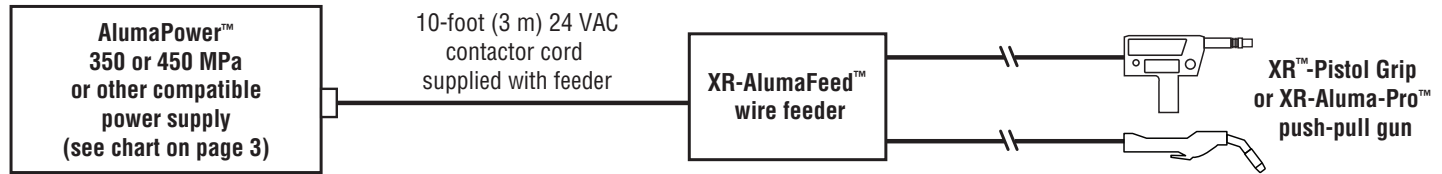

Ordering Information

Power Source and Options	Stock No.	Description	Qty.	Price
AlumaFeed™ Synergic Aluminum Welding Systems (Includes AlumaPower™ 350 MPa power source, XR-AlumaFeed™ wire feeder, gooseneck or pistol grip push-pull gun (air- or water-cooled), plus gun and feeder drive rolls and consumables to run .035–3/64 inch (0.9–1.2 mm) wire. Coolant system and 1/16-inch drive rolls and consumables not included — order separately below. Water-cooled packages have 115 V auxiliary power.)	#951 162	With 10-foot (3 m) air-cooled XR-Aluma-Pro™ gun		
	#951 158	With 15-foot (4.6 m) air-cooled XR-Aluma-Pro™ gun		
	#951 159	With 15-foot (4.6 m) water-cooled XR-Aluma-Pro™ gun		
	#951 147	With 25-foot (7.6 m) air-cooled XR-Aluma-Pro™ gun		
	#951 148	With 25-foot (7.6 m) water-cooled XR-Aluma-Pro™ gun		
	#951 160	With 35-foot (10.7 m) air-cooled XR-Aluma-Pro™ gun		
	#951 161	With 35-foot (10.7 m) water-cooled XR-Aluma-Pro™ gun		
	#951 163	With 15-foot (4.6 m) air-cooled XR-Pistol Grip gun		
	#951 164	With 15-foot (4.6 m) water-cooled XR-Pistol Grip gun		
	#951 149	With 30-foot (9 m) air-cooled XR-Pistol Grip gun		
#951 150	With 30-foot (9 m) water-cooled XR-Pistol Grip gun			
AlumaFeed™ MIGRunner™ Packages (Includes the same as above plus MIGRunner Cart and Industrial MIG 4/0 Kit with Dinse Connectors. Water-cooled packages have 115 V auxiliary power.)	#951 151	With 25-foot (7.6 m) air-cooled XR-Aluma-Pro™ gun		
	#951 152	With 25-foot (7.6 m) water-cooled XR-Aluma-Pro™ gun		
	#951 153	With 30-foot (9 m) air-cooled XR-Pistol Grip gun		
	#951 154	With 30-foot (9 m) water-cooled XR-Pistol Grip gun		
AlumaPower™ 350 MPa Power Source	#907 420	Power source only. 208–575 VAC with Auto-Line™		
	#907 420-00-1	Power source only. 208–575 VAC with Auto-Line™ and Auxiliary Power		
AlumaPower™ 450 MPa Power Source	#907 483	Power source only. 230/460 VAC with Auxiliary Power		
XR-AlumaFeed™ Wire Feeder	#300 509	Feeder only. Full synergic operation when used with MPa power sources only. Other Miller 14-pin power sources may be used, but feature operation may be limited. Call your Miller distributor for more information.		
XR-AlumaFeed™ Wire Feeder with Remote Connector	#300 509 001			
Gun Accessories				
XR-Aluma-Pro™ 1/16-inch (1.6 mm) Wire Kit	#230 708	Required with 1/16-inch Drive Roll Kit below to run 1/16-inch wire		
Replacement Cable Covers		See page 4		
Tube Assemblies and Liners		See page 4		
Feeder and Power Supply Accessories				
XR-AlumaFeed™ 1/16-inch (1.6 mm) Drive Roll Kit	#195 591	Required with 1/16-inch Wire Kit above to run 1/16-inch wire <i>Order from Miller Service Parts</i>		
Industrial MIG 4/0 Kit with Dinse Connectors	#300 405			
Remote Control Extension Kits	#242 205 025	25 ft. (7.6 m)		
	#242 205 050	50 ft. (15 m)		
	#242 205 080	80 ft. (24.3 m)		
Cable Connectors and Adapters		See page 7		
System Accessories				
Remote Connector Kit	#300 898	Field. For AlumaFeed wire feeder		
Safety Water Flow Shutdown Switch Kit	#300 905	Field. For water-cooled systems		
MIGRunner™ Cart	#195 445			
Universal Carrying Cart and Cylinder Rack	#042 934			
Coolant Systems		See page 7. See Lit. Index No. AY/7.2		

Date: Total Quoted Price:



Distributed by: